

# E40161

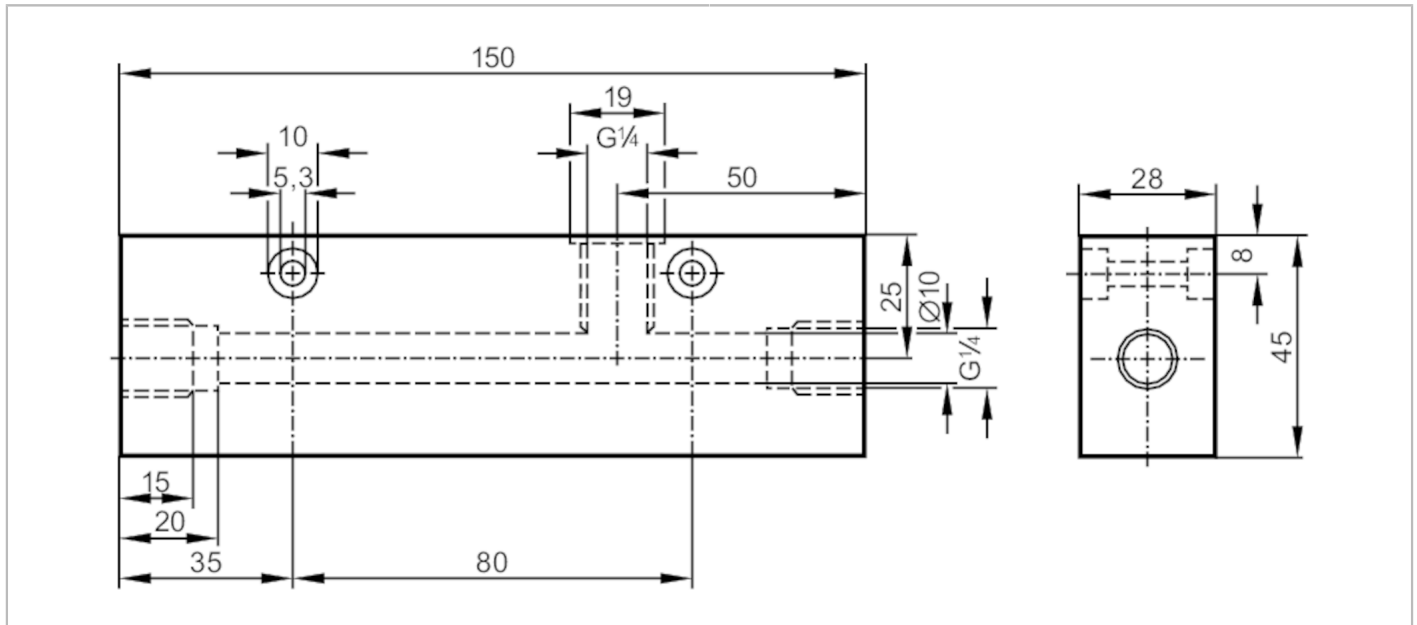

## Process adapter for small volumetric flow quantities

ADAPTBLOCK D10 G1/4



Application	
Design	for flow sensors SID, SF5
Flow range [l/min]	0.2...2; ((SI1xxx); 0.2...3 (SI5xxx); factory setting with water)
Application	for industrial applications
Media	liquids and gases
Pressure rating [bar]	300
Tests / approvals	
Pressure Equipment Directive	A possible classification to PED depends on the application and has to be carried out by the user / operator.
Pressure Equipment Directive EAC	The adapter is intended for use in devices, machines and installations that do not fall under the categories of the technical rule TR CU 032/2013.
Safety instructions	The compatibility between medium and product material has to be checked in all applications.
Mechanical data	
Weight [g]	1514
Materials	stainless steel (1.4404 / 316L)
Sensor connection	M18 x 1,5
Process connection	G 1/4
Accessories	
Items supplied	Adapter: 1 x G1/4 BSPP, E40099 sealings: 1, U-seal
Remarks	
Remarks	Can only be used in combination with the flow sensor's relative operating mode.
Pack quantity	1 pcs.