

MK5373

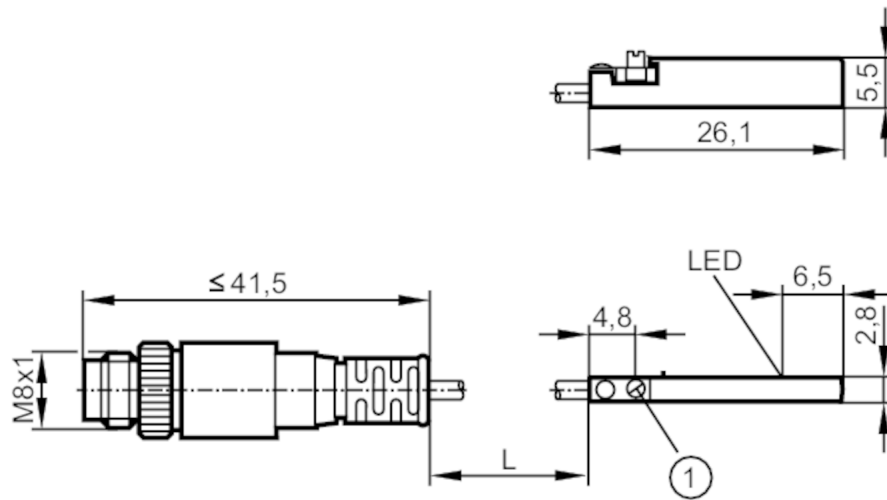

Cylinder sensor with GMR cell

MKC3028BAPKG/G/0,3M/ZH/ASR



1 fastening clamp



Product characteristics

Electrical design	PNP
Output function	normally closed
Dimensions [mm]	26.1 x 2.8 x 5.5

Electrical data

Operating voltage [V]	10...30 DC; ("supply class 2" to cULus)
Current consumption [mA]	< 10
Protection class	III
Reverse polarity protection	yes
Max. power-on delay time [ms]	30

Outputs

Electrical design	PNP
Output function	normally closed
Max. voltage drop switching output DC [V]	2.5
Permanent current rating of switching output DC [mA]	100
Switching frequency DC [Hz]	10000
Short-circuit protection	yes
Overload protection	yes

Detection zone

Response sensitivity [mT]	2.8
Travel speed [m/s]	> 10

Accuracy / deviations

Hysteresis [mm]	1.5
Repeatability [mm]	< 0.2

Operating conditions

Ambient temperature [°C]	-25...85
--------------------------	----------

MK5373



Cylinder sensor with GMR cell

MKC3028BAPKG/G/0,3M/ZH/ASR

Protection IP 65; IP 67

Tests / approvals

UL approval	Ta	-25...75 °C
	Enclosure type	Type 1
	power supply	Limited Voltage/Current (Marking Class 2)
	UL Approval no.	C008
	File number UL	E174191

Mechanical data

Weight [g]	12.3
Mounting	flush mountable
Cylinder type	C-slot cylinders
Dimensions [mm]	26.1 x 2.8 x 5.5
Materials	housing: PA; fastening clamp: stainless steel

Displays / operating elements

Display switching status 1 x LED, yellow

Remarks

Pack quantity 1 pcs.

Electrical connection - plug

Cable: 0.3 m, PUR

Connector: 1 x M8; coding: A; Locking: knurled nut, rotatable



Connection

