

E30424

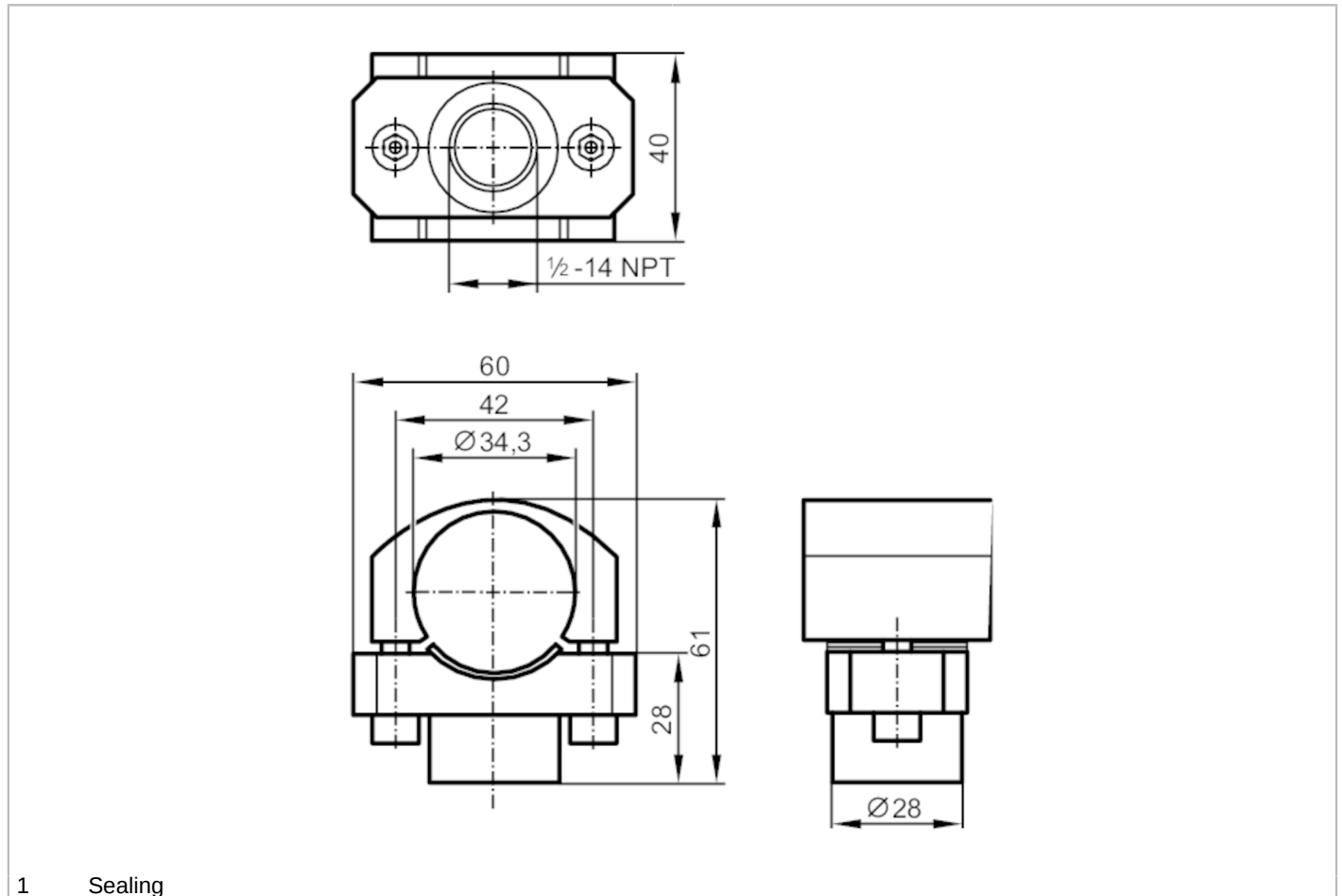

Conduit adapter mounting set for connectors

CONDUIT ADAPTER 1/2 NPT



Application	
Design	For pressure sensors with lateral connector, for protective tube with coupling, 1/2 - 14 NPT
Mechanical data	
Weight [g]	393.5
Materials	Clamping device: stainless steel (1.4305 / 303); clamp: stainless steel (1.4404 / 316L); Sealing: FKM
Tightening torque [Nm]	5; (see operating instructions)
Remarks	
Pack quantity	1 pcs.